

The **Archetype** Multi-Point Latch was designed for the Fleetwood Series 450-T Casement/Awning window system.

### Proprietary Design

The Archetype Multi-Point Latch was designed and engineered exclusively for Fleetwood products and is not available elsewhere on the market.

### Stainless Steel Components

The Archetype Multi-Point Latch is crafted from cast 316 stainless steel. Type 316 is a marine-grade stainless steel that is resistant to reactions such as corrosion and maintains its strength at elevated temperatures.

### Concealed Fasteners

The lever and housing were thoughtfully shaped for minimal presentation and comfortable operation. Additionally, our Engineers fashioned a method to conceal the attachment screws.

### Linear Design & Smooth Operation

The Archetype Multi-Point Latch was carefully engineered with cast stainless steel components in a linear, sleek design. Each component was custom formed to create a smooth latching motion.

### Extraordinary Process

The exposed surfaces of the latch are finished with a unique process called Electropolishing for a [Lifetime Warranty](#) in coastal applications. It is an electrochemical process that removes material from a metallic surface, reducing the roughness by levelling micro-peaks and valleys, while also improving the finish.

### Brushed or Black Finish

The Archetype Multi-Point Latch is offered in a brushed texture (fine bristle sanding that leaves a non-reflective surface) or black powder coated.

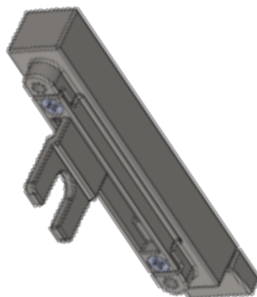

Multi-Point Latch

